

Lot 22 BLUELEAF DRIVE, NORTH PORT, Florida 34288

Listing

Call Scott with questions or to purchase this Lot Cell: 941-525-3758

T3539268 Lot 22 BLUELEAF DR, NORTH PORT, FL 34288

County: Sarasota

Status: Active
List Price: \$10,500.00



Total Acreage: 1/4 to less than 1/2

Flood Zone Code: X Flood insurance is not required is zone X

The city of North Port rezoned this area for development, creating a prime opportunity for Lot investors seeking a potential high return at a minimal price. The city's plans include a future off-ramp (exit) from I-75, enhancing accessibility to this area. This oversized Lot has a location advantage, and it is rezoned to R2, allowing for a single or two-family house. Everything from beaches, boating, fishing, golf, schools, and doctors are nearby. NOT on the Scrub Jay List. Put this Lot on your list to see! Reach out for more information.

Taxes: \$385	CDD:	Tax Year: 2023	Lot #: 22
Homestead:		Annual CDD Fee:	Other Exemptions:
AG Exemption YN:			
Alt Key/Folio #: 1151217422	# of Parcels:	Additional Tax IDs:	Development:
Add Parcel: No		Complex/Comm Name:	Subdiv/Condo:
Ownership: Fee Simple		Land Lease Fee:	Lot Size: 12,292 SqFt / 1,142 SqM
Book/Page: 19-45		Lot Size Acres: 0.28	
Lot Dimensions: 126.51x125x32.72		Waterfront Ft: 0	
Water Frontage: No			
Utilities: Electrical Nearby		Road Surface Type: Asphalt	
Sewer: Septic Needed			
Horse Amenities:			

Community Information

HOA / Comm Assn: No	HOA Fee:	HOA Pmt Sched:	Mo Maint\$(add HOA):
Master Assn/Name: No		Master Assn Fee:	Master Assn Ph:
Elementary School: Atwater Elementary		Middle School: Woodland Middle School	High School: North Port High

La ciudad de North Port rezonificó esta área para desarrollo, creando una excelente oportunidad para los inversores de lotes que buscan un alto rendimiento potencial a un precio mínimo. Los planes de la ciudad incluyen una futura rampa de salida de la I-75, mejorando la accesibilidad a esta área. Este lote de gran tamaño tiene una ventaja de ubicación y está rezonificado a R2, lo que permite una casa unifamiliar o bifamiliar. Todo, desde playas, paseos en bote, pesca, golf, escuelas y médicos, está cerca. NO en la lista Scrub Jay. ¡Pon este lote en tu lista para verlo! Comuníquese para obtener más información.

Photos



Parcel Map

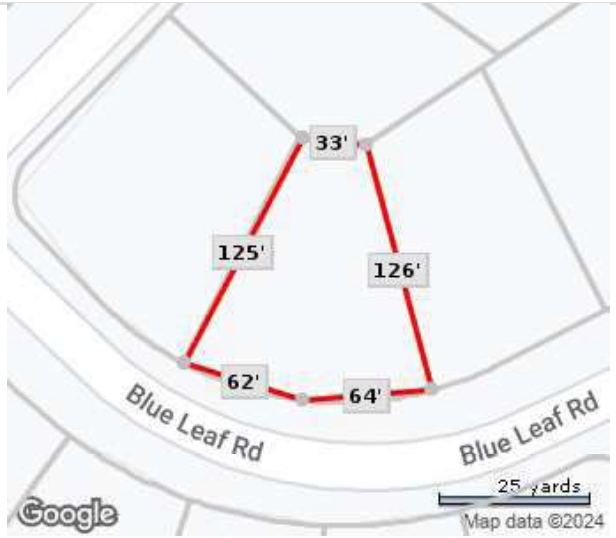

SunQuest Real Estate LLC
www.SunQuestNow.Com
 941-882-5494 Ext 701
 813-324-1005 Ext 701